

FlexBollard-XL™

Heavy-Duty Flexible Bollard

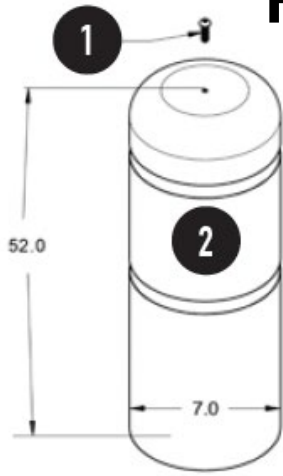

#	Qty	Part #	Description
1	1	73780	5/16" – 18 x 1" Hex Drive Cap Screw
2	1	RE-BC52	52 x 7" Bollard Cover
3	1	RE-XL-BC	Anti-Rotate Bollard Cap Kit
4	2	RE-FR-7	7" Foam Spacer Ring
5	1	RE-XL-47P	48.5" x 2 3/8" Steel Post - .055" Wall
6	1	A-XL-SK	8 x 8" Base & Spring Assembly
7	2	0176637	5/16" – 18 X 3/8" Cone Point Set Screw

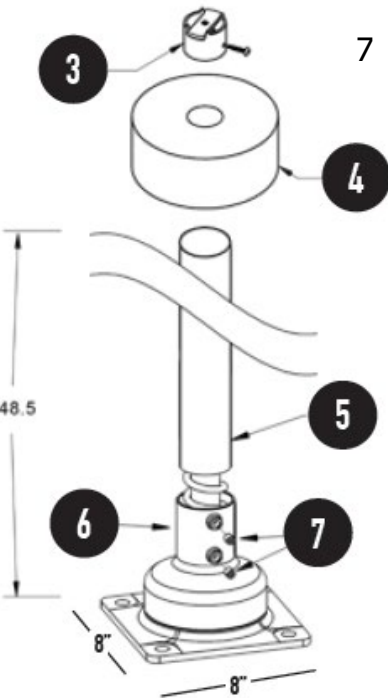

Anchoring Options

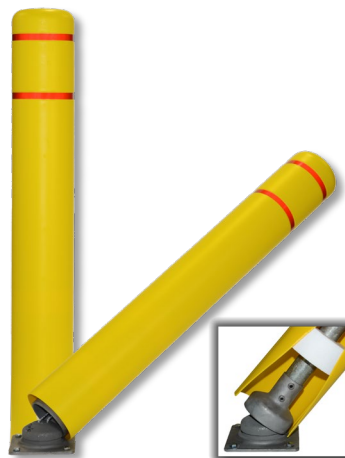
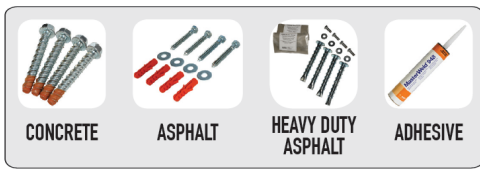

Installation Guides:

flexpostinc.com/install



2236 112th Ave., #80 · Holland, MI 49424
888-307-6610 · flexpostinc.com
Email: sales@flexpost.net



FlexPost[®] Quick Start Guide

Step 1: Secure the Base

STANDARD



XL



Types of Anchoring Hardware and Tools Required for Mounting

Asphalt



3/4" Masonry Drill Bit
15/16" Ratchet

Heavy Duty Asphalt



3/8 Cup of Water
7/8" Masonry Drill Bit
9/16" Ratchet

Concrete



High Speed Drill
1/2" Masonry Drill Bit
3/4" Ratchet

Adhesive



Standard Caulk Gun

Ground



3/4" Wrench
3/4" Ratchet

XL Ground



Quick Setting Cement
2 x 1/2" Ratchet

Step 2: Attach Spring [Standard] Insert Set Screw [XL]

STANDARD



1/2" Ratchet

XL



Step 3: Install Bollard (If Applicable)

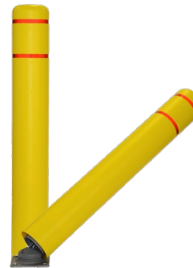

Step 4: Attach Sign Brackets



Anchoring/Installation/Warranty Info

flexpostinc.com/install

